

LEVEL

# G

OFFICE

14,333 sq ft

RECEPTION, CAFE & LOBBY

6,381 sq ft

DRUMMOND STREET RECEPTION

1,986 sq ft

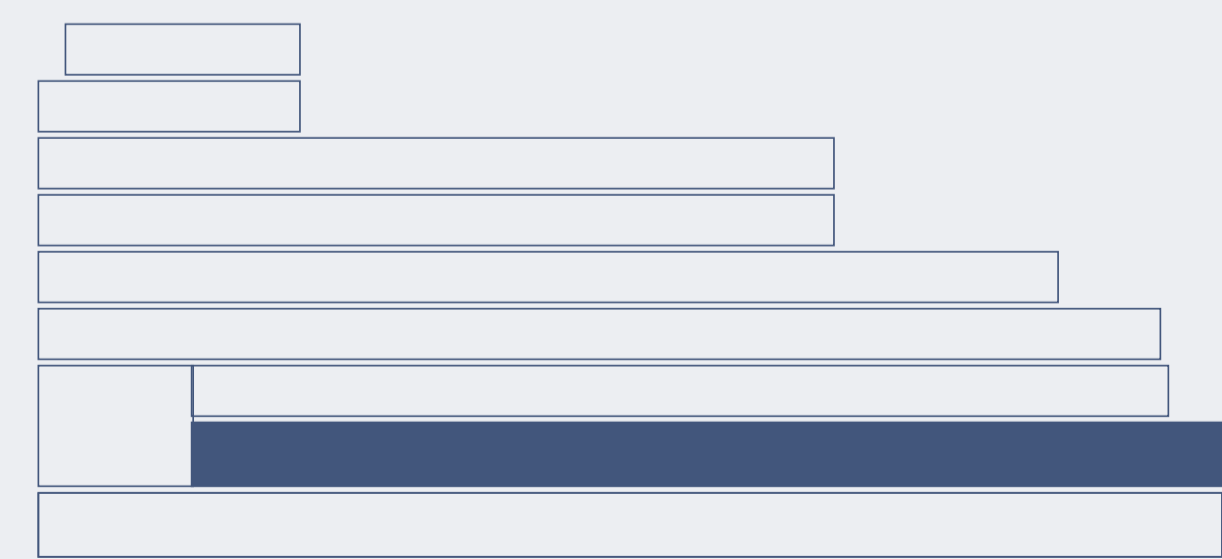
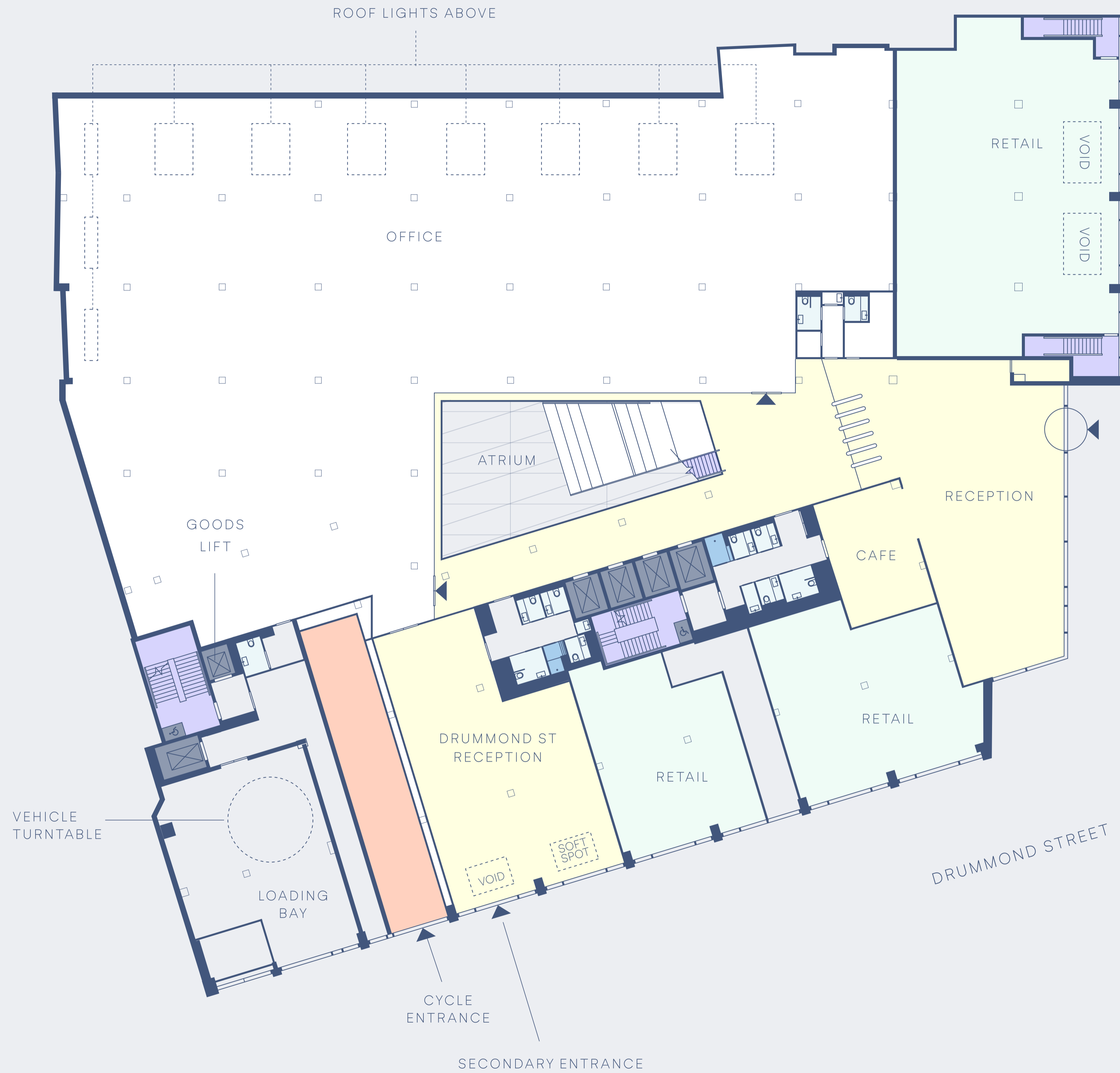

- Office space
- Reception & lobby
- Car & bike access
- Retail
- Lift
- Stairs
- WC
- Shower
- Entrance

Plans are not to scale and are indicative NIA only.