

LEVEL

4

OFFICE

13,434 sq ft

TERRACE

5,258 sq ft

POCKET GARDEN

143 sq ft

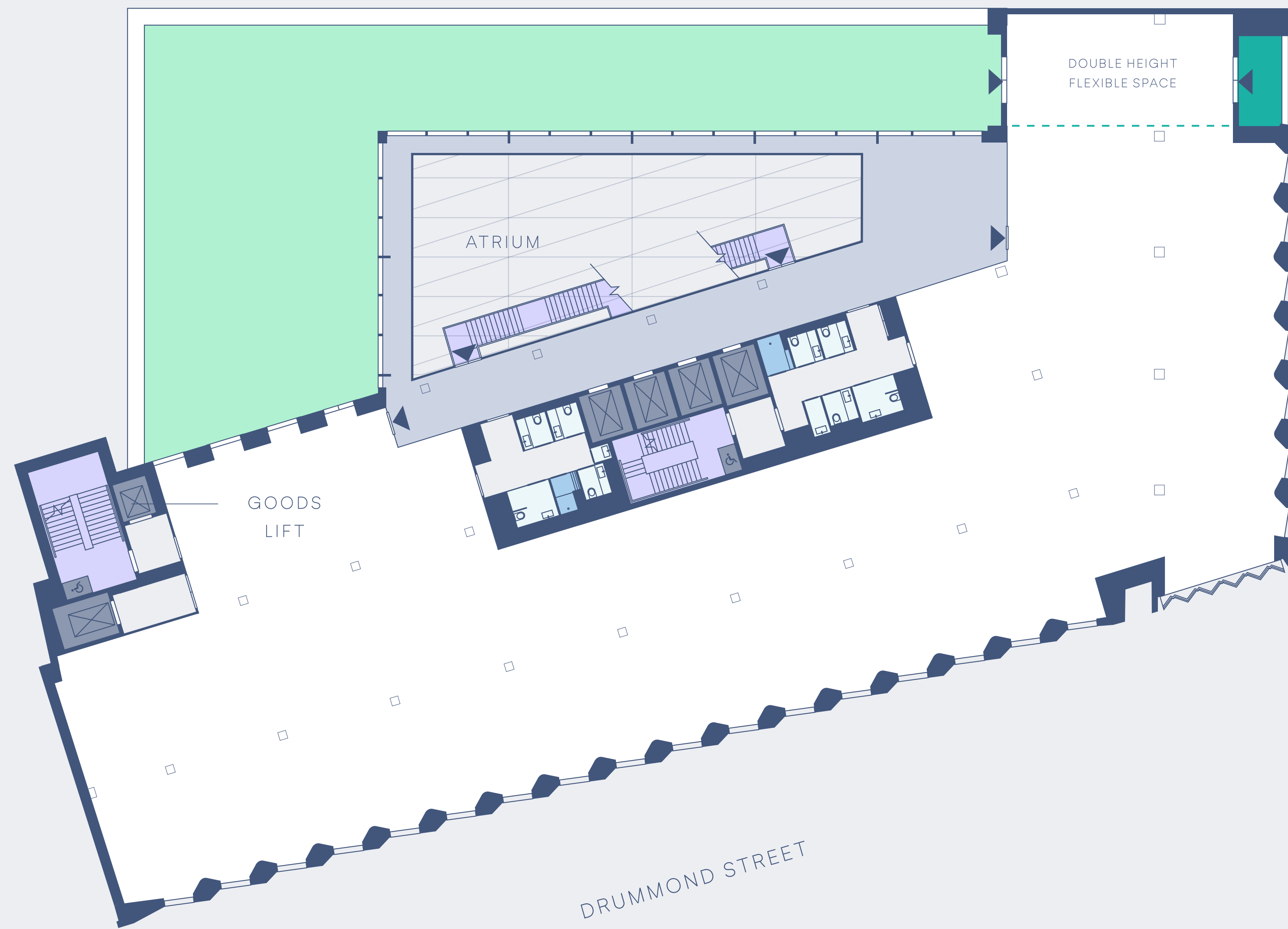

HAMPSTEAD ROAD

DRUMMOND STREET

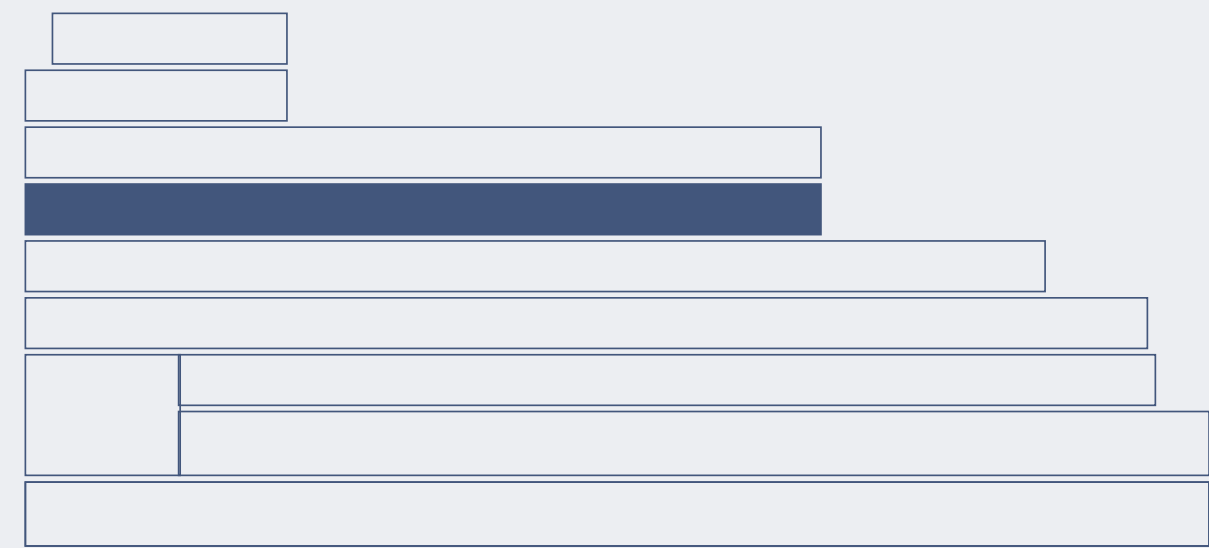

- Office space
- Terrace
- Pocket Garden
- Lift
- Stairs
- Lobby
- WC
- Shower
- Entrance

Plans are not to scale and are indicative NIA only.