

LEVEL

# G

OFFICE

14,333 sq ft

RECEPTION, CAFE & LOBBY

6,381 sq ft

DRUMMOND STREET RECEPTION

1,986 sq ft

## Open plan

164 SEATS  
(EXCL. BREAKOUT SPACES)

8M<sup>2</sup> PER PERSON

128 DESKS

4 MEETING ROOMS

45 BREAKOUT SPACES

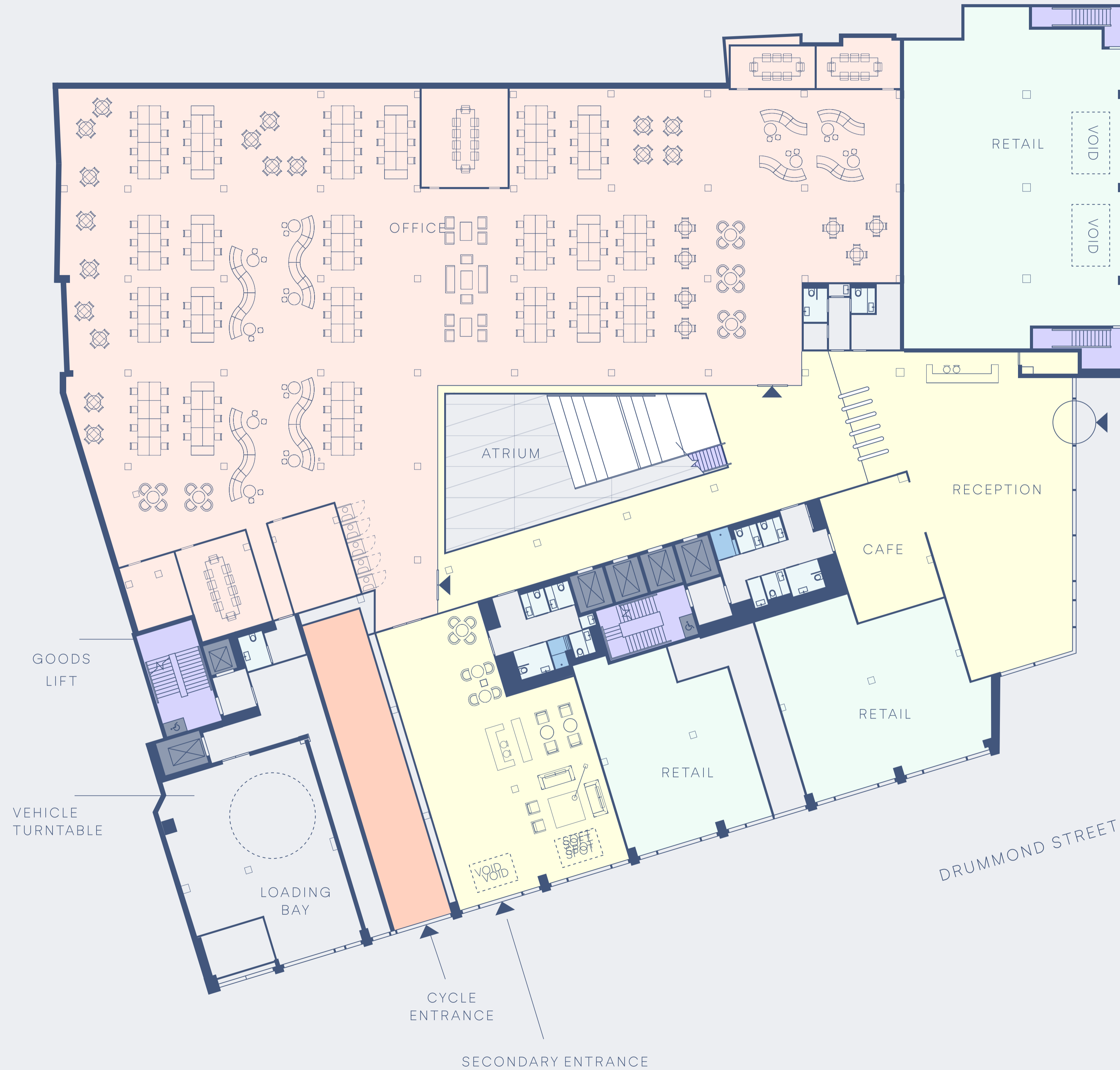
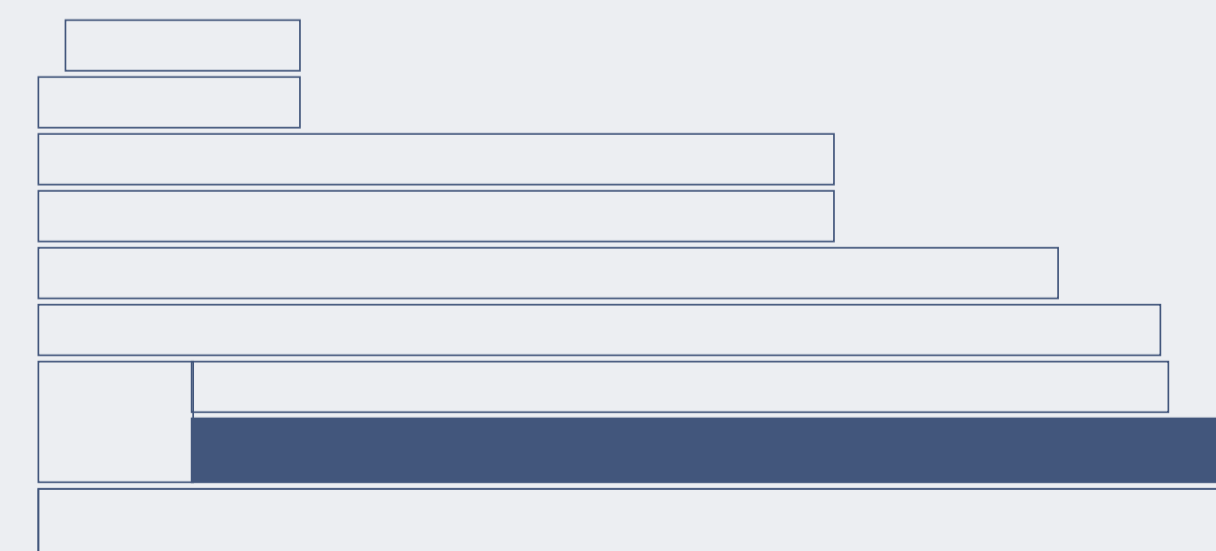

HAMPSTEAD ROAD

DRUMMOND STREET

- Open plan space
- Reception & lobby
- Car & bike access
- Lift
- Retail
- Stairs
- WC
- Shower
- Entrance

Plans are not to scale and are indicative NIA only.